

TRACK

TRACKS 1,5MM FOR INDUSTRIAL SECTIONAL DOORS

SHORT CURVE R305

ARTICLE: 13014

Short curve R=305 for garage doors
Material: Galvanised steel 1,5mm

Factory price: 11.85 € excl. VAT / piece
Weight: 0.72 kg **Shipping class:** Standard

SHORT CURVE HORIZONTAL TRACK 1,5MM WITH HOLES L= 2836MM

ARTICLE: 2836

Short curve horizontal track 1,5mm with holes for garage doors with low lintel
Length: 2836mm
For the door height: 2375mm

Factory price: 27.16 € excl. VAT / piece
Weight: 5.7 kg **Shipping class:** Dłużyca

SHORT CURVE HORIZONTAL TRACK 1,5MM WITH HOLES L= 3461MM

ARTICLE: 3461

Short curve horizontal track 1,5mm with holes for garage doors with low lintel
Length: 3461mm
For the door height: 3000mm

Factory price: 29.03 € excl. VAT / piece
Weight: 7.02 kg **Shipping class:** Dłużyca

TRACK 1,5MM WITHOUT HOLES, L=5000

ARTICLE: 0500.1

Vertical track 1,5mm for industrial sectional doors
Material: Galvanised steel
Length: 5000mm

Factory price: 41.00 € excl. VAT / piece
Weight: 5.5 kg **Shipping class:** Dłużyca

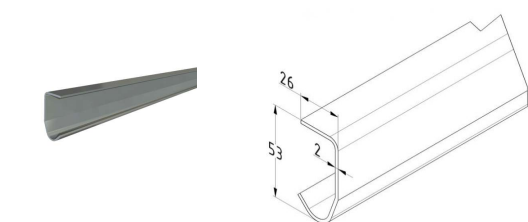
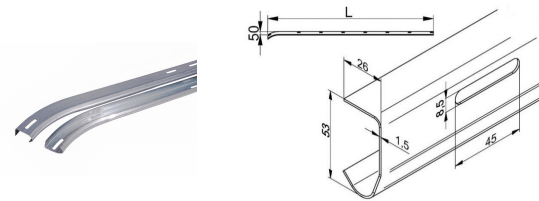
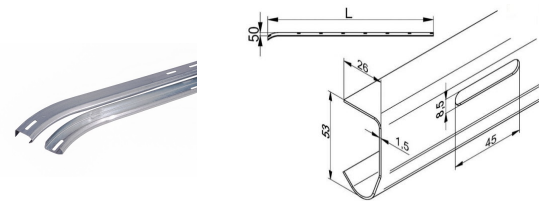
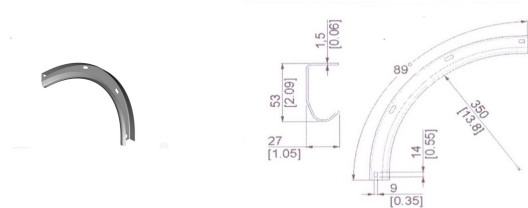

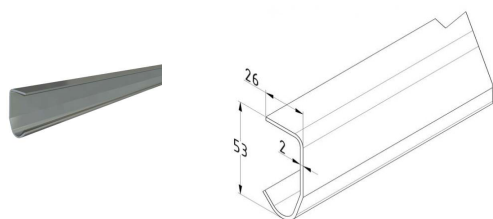

TRACK 1,5MM WITHOUT HOLES, L=6000

ARTICLE: 0600.1

Vertical track 1,5mm for industrial sectional doors

Material: Galvanised steel

Length: 6000mm

Factory price: 41.00 € excl. VAT / piece

Weight: 6.5 kg **Shipping class:** Dłużyca

TRACKS 1,75MM FOR INDUSTRIAL SECTIONAL DOORS

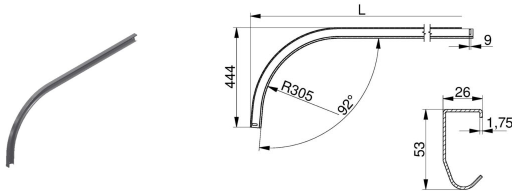

CURVES R=305 L=3650MM

ARTICLE: 3650

Application: Industrial, Low Headroom (LHI).
Material: Zinc plated steel
L=3650mm

Factory price: 11.85 € excl. VAT / piece
Weight: 10 kg **Shipping class:** Standard

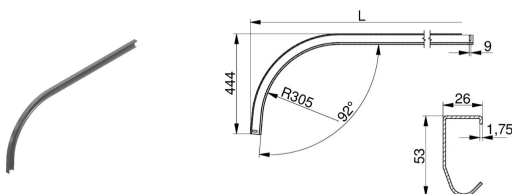

CURVES R=305 L=5650MM

ARTICLE: 5650

Application: Industrial, Low Headroom (LHI).
Material: Zinc plated steel
L=5650mm

Factory price: 11.85 € excl. VAT / piece
Weight: 15.4 kg **Shipping class:** Standard

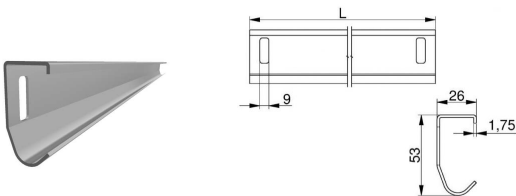

VERTICAL TRACK WITH HOLES 1,75MM , L=3000MM

ARTICLE: 3000

Horizontal track 1,75mm with holes for track bolts for sectional doors
Material: Galvanised steel
Holes 25x9mm located at the track ends
Lenght: 3000mm

Factory price: 22.00 € excl. VAT / piece
Weight: 4.07 kg **Shipping class:** Dłużyca

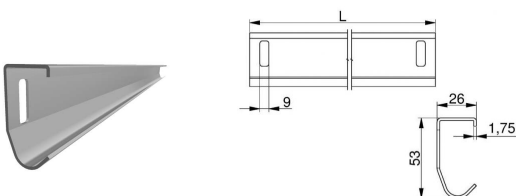

VERTICAL TRACK WITH HOLES 1,75MM , L=3500MM

ARTICLE: 3500

Horizontal track 1,75mm with holes for track bolts for sectional doors
Material: Galvanised steel
Holes 25x9mm located at the track ends
Lenght: 3500mm

Factory price: 26.00 € excl. VAT / piece
Weight: 4.75 kg **Shipping class:** Dłużyca

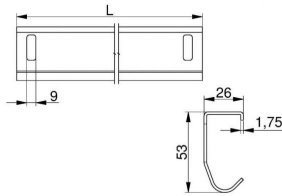
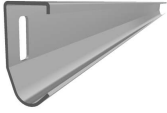

VERTICAL TRACK WITH HOLES 1,75MM , L=5000MM

ARTICLE: 5000

Horizontal track 1,75mm with holes for track bolts for sectional doors
Material: Galvanised steel
Holes 25x9mm located at the track ends
Length: 5000mm

Factory price: 37.00 € excl. VAT / piece
Weight: 6.78 kg **Shipping class:** Dłuzyca

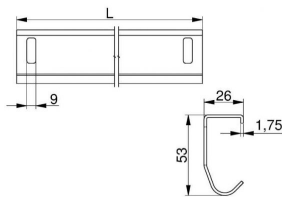

VERTICAL TRACK WITH HOLES 1,75MM , L=5500MM

ARTICLE: 5500

Horizontal track 1,75mm with holes for track bolts for sectional doors
Material: Galvanised steel
Holes 25x9mm located at the track ends
Length: 5500mm

Factory price: 41.00 € excl. VAT / piece
Weight: 7.45 kg **Shipping class:** Dłuzyca

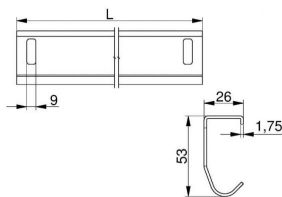

VERTICAL TRACK WITH HOLES 1,75MM , L=6000MM

ARTICLE: 6000

Horizontal track 1,75mm with holes for track bolts for sectional doors
Material: Galvanised steel
Holes 25x9mm located at the track ends
Length: 6000mm

Factory price: 44.00 € excl. VAT / piece
Weight: 8.14 kg **Shipping class:** Dłuzyca

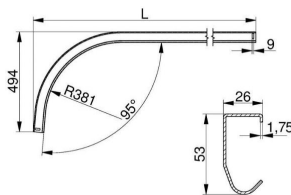

HORIZONTAL TRACK 1,75MM WITH CURVE R381-95 FOR HIGH LIFT SECTIONAL DOORS L=1100MM

ARTICLE: 1100

Horizontal track 1,75mm with curve R381-95 for high lift industrial sectional doors,
Material: Galvanised steel
Length: 1100mm
use together with tracks 220000-

Factory price: 42.59 € excl. VAT / piece
Weight: 4 kg **Shipping class:** Dłuzyca

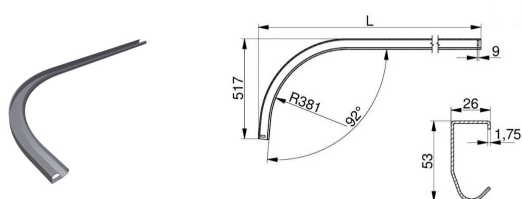

**HORIZONTAL TRACK 1,75MM WITH CURVE R381-92,
L=1100MM**

ARTICLE: 1100

Horizontal track 1,75mm with curve R381-92 for standard lift
industrial doors
Material: Galvanised steel 1,75mm
Length: 1100mm

Factory price: 24.37 € excl. VAT / piece
Weight: 3 kg **Shipping class:** Dłużyca

TRACKS 2,00MM FOR INDUSTRIAL SECTIONAL DOORS

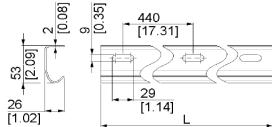
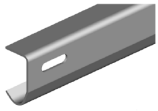

STRAIGHT TRACK 2.0MM PERFORATED L = 1818MM

ARTICLE: L

Material: galvanized steel

Factory price: 11.85 € excl. VAT / piece

Weight: 2.55 kg **Shipping class:** Standard

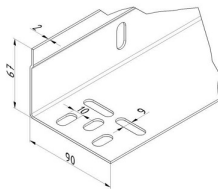
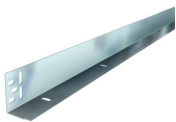

VERTICAL ANGLE 90X67X2,0MM, L=6500MMWITH PERFORATIONS

ARTICLE: 3696

material: galvanized steel

Lenght: 6500mm

use together with 24740

Factory price: 90.00 € excl. VAT / piece

Weight: 15.56 kg **Shipping class:** Dłużyca

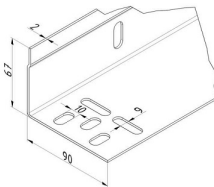
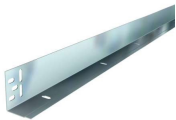

VERTICAL ANGLE 90X67X2,0MM, L=6000MMWITH PERFORATIONS

ARTICLE: 3690

material: galvanized steel

Lenght: 6000mm

use together with 24740

Factory price: 83.00 € excl. VAT / piece

Weight: 14.36 kg **Shipping class:** Dłużyca

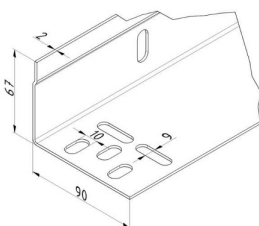
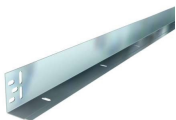

VERTICAL ANGLE 90X67X2,0MM, L=5000MMWITH PERFORATIONS

ARTICLE: 3695

material: galvanized steel

Lenght 5000mm

use together with 24740

Factory price: 69.00 € excl. VAT / piece

Weight: 11.97 kg **Shipping class:** Dłużyca

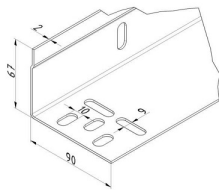

VERTICAL ANGLE 90X67X2,0MM, L=4000MM WITH PERFORATIONS

ARTICLE: 3692

material: galvanized steel
Lenght 4000mm
use together with 24740

Factory price: 56.00 € excl. VAT / piece
Weight: 9.58 kg **Shipping class:** Dłużyca

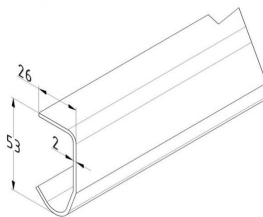

TRACK 2,0MM WITHOUT HOLES, L=4400

ARTICLE: 1440

Vertical track 2,0mm for industrial sectional doors
Material: Galvanised steel
Lenght: 4400mm

Factory price: 31.00 € excl. VAT / piece
Weight: 6.16 kg **Shipping class:** Dłużyca

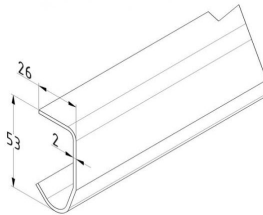

TRACK 2,0MM WITHOUT HOLES, L=5000

ARTICLE: 1500

Vertical track 2,0mm for industrial sectional doors
Material: Galvanised steel
Lenght: 5000mm

Factory price: 34.00 € excl. VAT / piece
Weight: 7 kg **Shipping class:** Dłużyca

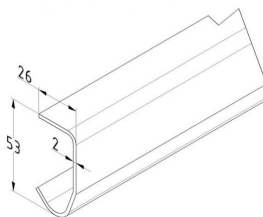

TRACK 2,0MM WITHOUT HOLES, L=6000

ARTICLE: 1600

Vertical track 2,0mm for industrial sectional doors
Material: Galvanised steel
Lenght: 6000mm

Factory price: 41.00 € excl. VAT / piece
Weight: 8.4 kg **Shipping class:** Dłużyca

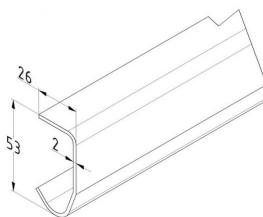

TRACK 2,0MM WITHOUT HOLES, L=6500

ARTICLE: 1650

Vertical track 2,0mm for industrial sectional doors
Material: Galvanised steel
Lenght: 6500mm

Factory price: 45.00 € excl. VAT / piece
Weight: 9.1 kg **Shipping class:** Dłużyca

TRACK 2,0MM WITH CURVE R381-92 WITHOUT HOLES, H=3238MM

ARTICLE: 2290

Track 2,0mm with curve R=381 -92° for industrial sectional doors
 Material: Galvanised steel 2,0mm
 Max door height: 2800mm
 Length: 3760mm

Factory price: 46.00 € excl. VAT / piece
Weight: 10.5 kg **Shipping class:** Dłużyca

TRACK 2,0MM WITH CURVE R381-92 WITHOUT HOLES, H=3058MM

ARTICLE: 2300

Track 2,0mm with curve R=381 -92° for industrial sectional doors
 Material: Galvanised steel 2,0mm
 Max door height: 2620mm
 Length: L=3577mm, H=3058mm, B=754mm

Factory price: 67.00 € excl. VAT / piece
Weight: 8 kg **Shipping class:** Dłużyca

TRACK 2,0MM WITH CURVE R381-92 WITHOUT HOLES, H=3878MM

ARTICLE: 2360

Track 2,0mm with curve R=381 -92° for industrial sectional doors
 Material: Galvanised steel 2,0mm
 Max door height: 3440mm
 Length: L=4400mm, H=3878mm, B=754mm

Factory price: 80.00 € excl. VAT / piece
Weight: 12.32 kg **Shipping class:** Dłużyca

TRACK 2,0MM WITH CURVE R381-92 WITHOUT HOLES, H=4478MM

ARTICLE: 2420

Track 2,0mm with curve R=381 -92° for industrial sectional doors
 Material: Galvanised steel 2,0mm
 Max door height: 4040mm
 Length: 5000mm

Factory price: 92.00 € excl. VAT / piece
Weight: 14 kg **Shipping class:** Dłużyca

TRACK 2,0MM WITH CURVE R381-92° WITHOUT HOLES, H=5478MM

ARTICLE: 2520

Track 2,0mm with curve R=381 -92° for industrial sectional doors
Material: Galvanised steel 2,0mm
Max door height: 5040mm
Length: 6000mm

Factory price: 112.00 € excl. VAT / piece
Weight: 16.8 kg **Shipping class:** Dłużyca

TRACK 2MM WITH PITCHED CURVE R381, B=100°

ARTICLE: 15105

Track 2,0mm with curve R=381 for sectional door installation along roof inclination.

Material: Galvanised steel 2mm
Length of straight track: 6000mm
Track opening angle: $\beta=100^\circ$
Roof inclination angle: $\alpha=10^\circ$

Factory price: 112.00 € excl. VAT / piece
Weight: 16.8 kg **Shipping class:** Dłużyca

TRACK 2MM WITH PITCHED CURVE R381, B=105°

ARTICLE: 15106

Track 2,0mm with curve R=381 for sectional door installation along roof inclination.

Material: Galvanised steel 2mm
Length of straight track: 6000mm
Track opening angle: $\beta=105^\circ$
Roof inclination angle: $\alpha=15^\circ$

Factory price: 112.00 € excl. VAT / piece
Weight: 16.8 kg **Shipping class:** Dłużyca

TRACK 2MM WITH PITCHED CURVE R381, B=120°

ARTICLE: 15109

Track 2,0mm with curve R=381 for sectional door installation along roof inclination

Material: Galvanised steel 2mm
Length of straight track: 6000mm
Track opening angle: $\beta=120^\circ$
Roof inclination angle: $\alpha=30^\circ$

Factory price: 121.00 € excl. VAT / piece
Weight: 16.8 kg **Shipping class:** Dłużyca

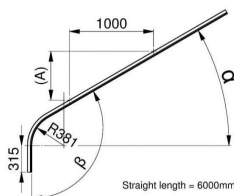
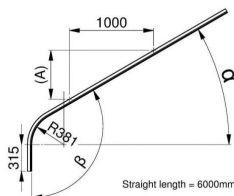
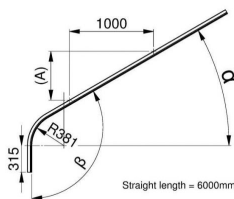

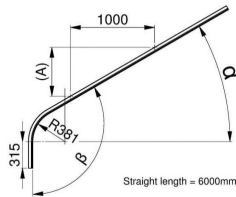

TRACK 2MM WITH PITCHED CURVE R381, B=130°

ARTICLE: 15111

Track 2,0mm with curve R=381 for sectional door installation along roof inclination

Material: Galvanised steel 2mm

Length of straight track: 6000mm

Track opening angle: $\beta=130^\circ$

Roof inclination angle: $\alpha =40^\circ$

Factory price: 67.85 € excl. VAT / piece

Weight: 16.8 kg **Shipping class:** Dłużyca

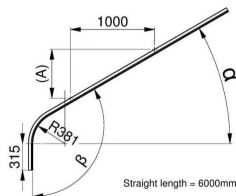

TRACK 2MM WITH PITCHED CURVE R381, B=135°

ARTICLE: 15112

Track 2,0mm with curve R=381 for sectional door installation along roof inclination.

Material: Galvanised steel 2mm

Length of straight track: 6000mm

Track opening angle: $\beta=135^\circ$

Roof inclination angle: $\alpha =45^\circ$

Factory price: 112.00 € excl. VAT / piece

Weight: 16.8 kg **Shipping class:** Dłużyca

TRACKS FOR SECTIONAL DOORS

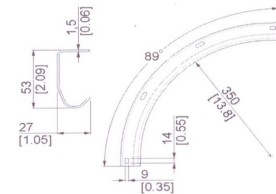

SHORT CURVE R305

ARTICLE: 13014

Short curve R=305 for garage doors
Material: Galvanised steel 1,5mm

Factory price: 11.85 € excl. VAT / piece

Weight: 0.72 kg **Shipping class:** Standard

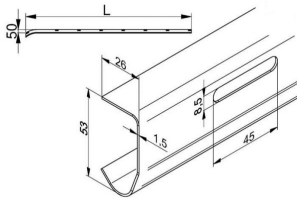

SHORT CURVE HORIZONTAL TRACK 1,5MM WITH HOLES L= 3461MM

ARTICLE: 3461

Short curve horizontal track 1,5mm with holes for garage doors with low lintel

Length: 3461mm

For the door height: 3000mm

Factory price: 29.03 € excl. VAT / piece

Weight: 7.02 kg **Shipping class:** Dłużyca

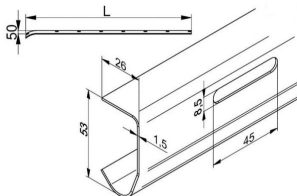
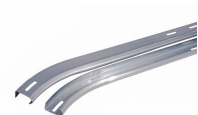

SHORT CURVE HORIZONTAL TRACK 1,5MM WITH HOLES L= 2836MM

ARTICLE: 2836

Short curve horizontal track 1,5mm with holes for garage doors with low lintel

Length: 2836mm

For the door height: 2375mm

Factory price: 27.16 € excl. VAT / piece

Weight: 5.7 kg **Shipping class:** Dłużyca

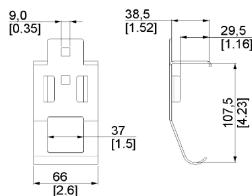

TRACK BRACKET V2

ARTICLE: 98514

material: zinc plated steel

Factory price: 11.85 € excl. VAT / piece

Weight: 0.152 kg **Shipping class:** Standard

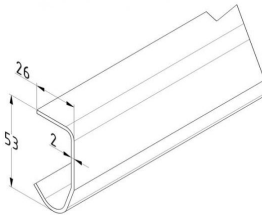

TRACK 1,5MM WITHOUT HOLES, L=5000

ARTICLE: 0500.1

Vertical track 1,5mm for industrial sectional doors

Material: Galvanised steel

Length: 5000mm

Factory price: 41.00 € excl. VAT / piece

Weight: 5.5 kg **Shipping class:** Dłużyca

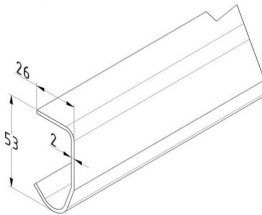

TRACK 1,5MM WITHOUT HOLES, L=6000

ARTICLE: 0600.1

Vertical track 1,5mm for industrial sectional doors

Material: Galvanised steel

Length: 6000mm

Factory price: 41.00 € excl. VAT / piece

Weight: 6.5 kg **Shipping class:** Dłużyca